

PA1500 – Rail for transfer car

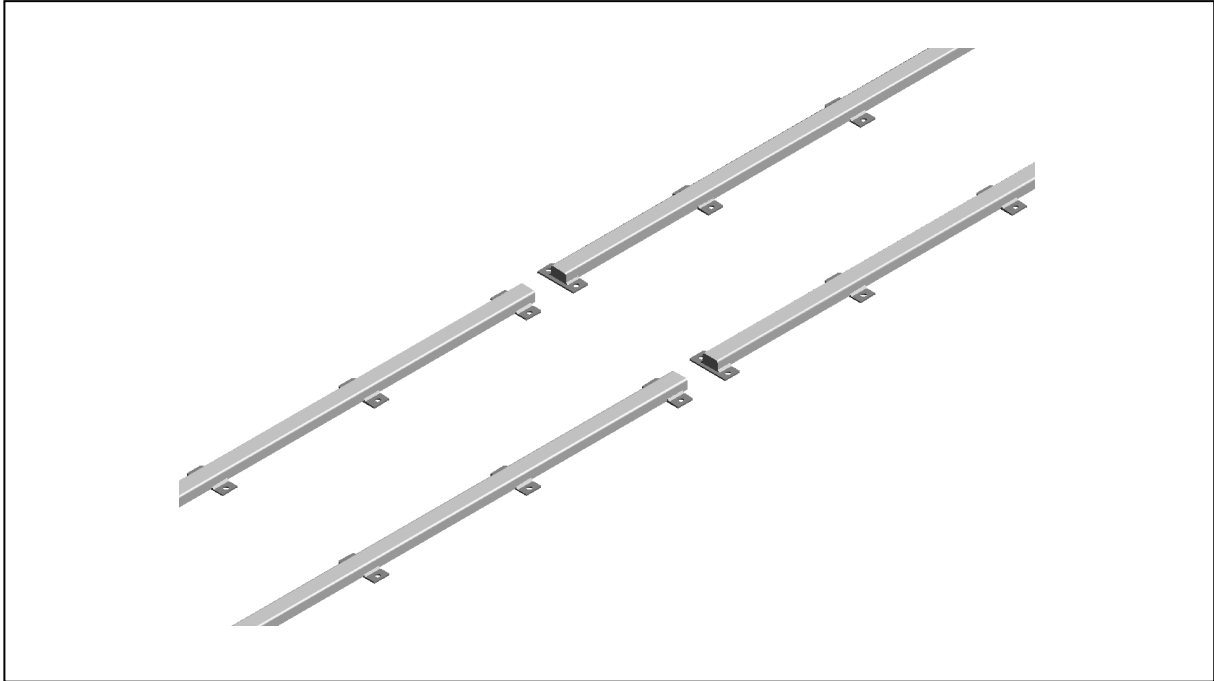

Area of usage:

Rail for transfer car when the quality of the floor and inclination does not allow the car to be driven directly on the floor.

Technical data:

Design: Rail 50x30 mm.
Height: Top side of rail is 35 mm over the floor (at even floor).

Surface treatment:

Untreated.

Other:

Levelling plate as accessory, see next side.

PA1500 – Levelling plate for rail

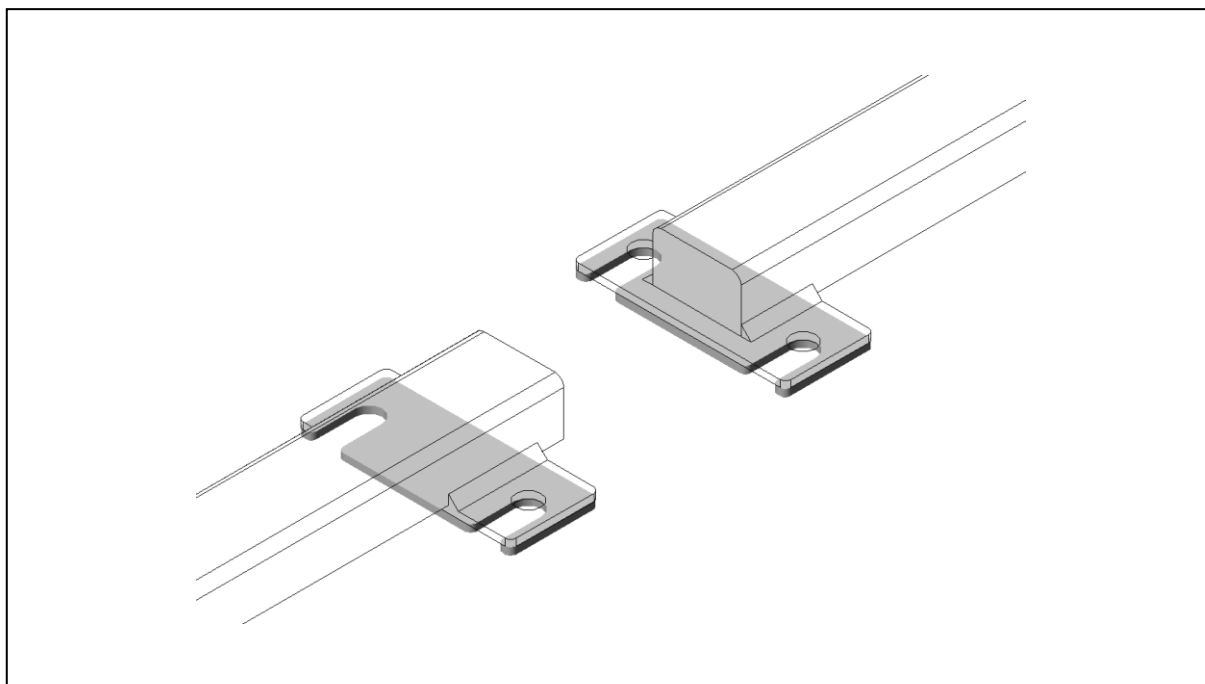

Area of usage:

Levelling plate for rail to transfer car to fill up uneven parts of the floor.

Technical data:

Design: Steel plate.
Thickness: 1, 2, 4 and 8 mm.

Surface treatment:

Zink plated.

Other:

Note! The article number is for 1 levelling plate.

Article number:

Thickness	
1 mm	3806130764
2 mm	3806130774
4 mm	3806130784
8 mm	3806130794

Ensure the article number is stated when ordering.