

KE 500 - Double angle conveyor, pneumatic - Type DV

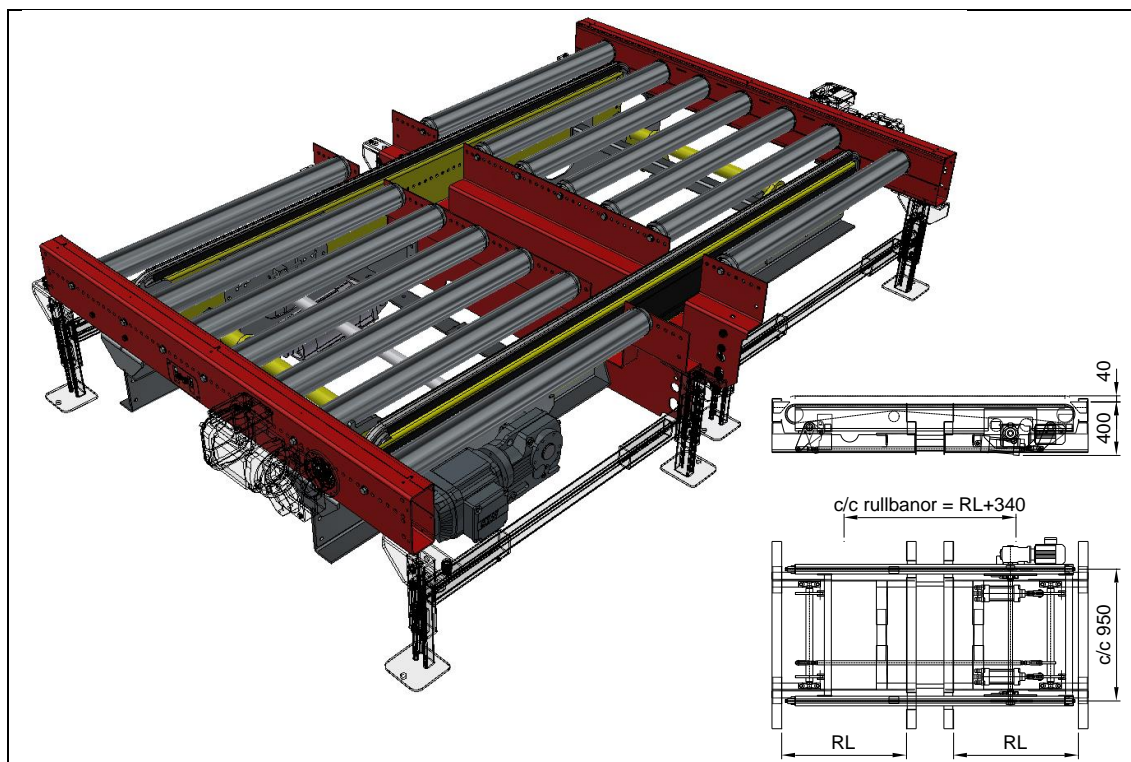

Area of application:

With the help of chain conveyors, move goods transversely between two runway lines.

Technical data:

Function:	Height-adjustable chain conveyor mounted in two parallel roller conveyors.
Lifting movement	Via two torque axes, the movement of the one to two pneumatic cylinders is transmitted to the height and lower movement.
Air consumption:	13.0 NL / cycle / cylinder.
Lifting capacity:	250 kg with one cylinder. 500 kg with two cylinders.
Cylinder:	VDMA-normed.
Conveyor chain:	3/8" or 3/4" roller chain with straight side washers.
Drives:	For KT: Side-mounted gear motor For RB: See motor lists
Transport speeds:	6, 9 and 12.9 m/min (for cross-transport).
Available for roller length:	900 and 1100 mm.
Available for length (RB):	1330mm.